

# 5 ITEMS TECHNOLOGICAL INNOVATION

## 项技术创新

1

### 完美设计

符合人体工程学  
爬坡不再感到无力

Ergonomic  
Climbing no longer  
feel powerless

2

### 更抓脚

铝合金表面  
防滑齿设计更抓脚  
野外竞赛无压力

Aluminum alloy surface  
Non-slip tooth design  
is more grasping feet  
Field competition  
without pressure

3

### 金属光泽

阳极化工艺  
时刻保持金属光泽

Anodizing process  
Keep the metal luster

4

### 轴芯系统

采用  
全新轴芯系统入手

used  
New shaft core  
system to start

5

### 铝合金主体

高强度铝合金主体  
整体重量更轻

High strength  
aluminum alloy body  
The overall weight is  
lighter

## 目录

Page

<b>PEDAL SEALED BEARING SYSTEM</b>	01
NEW ITEM ILLUSTRATION	02
FREERIDE	03
FREERIDE/CITY/MTB/BMX PEDAL	04/05
<b>PEDAL DU BEARING SYSTEM</b>	06
COMFORT/CITY/MTB PEDAL	07
COMFORT/CITY PEDAL	08
<b>PEDAL BALL BEARING SYSTEM</b>	09
COMFORT/CITY Classic Type PEDAL	10
MTB/BMX PEDAL	11/12
MTB PEDAL	13
COMFORT/CITY PEDAL	14
FOLDING PEDAL	15
E-BIKE PEDAL	16
COMFORT/CITY/BEACH CRUISER PEDAL	17
BMX/MTB/CITY PEDAL	18
MTB/BMX/CITY PEDAL	19
MTB/BMX PEDAL	20
MTB/COMFORT/CITY PEDAL	21
COMFORT/CITY PEDAL	22
<b>PEDAL BALL-LESS BEARING SYSTEM</b>	23
KID'S BIKE PEDAL	24
KID'S BIKE PEDAL	25
KID'S BIKE PEDAL	26
KID'S BIKE PEDAL	27
EXERCISE PEDAL	28/29
STRAPS PEDAL	30
ACCESSORIES	31
<b>PEDAL SPINDLE EXTENDER &amp; ADAPTER--ILLUSTRATION</b>	32
BRAKE LEVER	33/34
AFTER MARKET PACKAGE	35/36



MTB



COMFORT



ROAD



BMX



EXERCISE



FOLDING



BEARING  
STRUCTRE

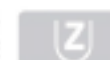

ZU STRUCTURE



CHILDREN'S



# PEDAL SEALED BEARING SYSTEM



# NEW ITEM ILLUSTRATION

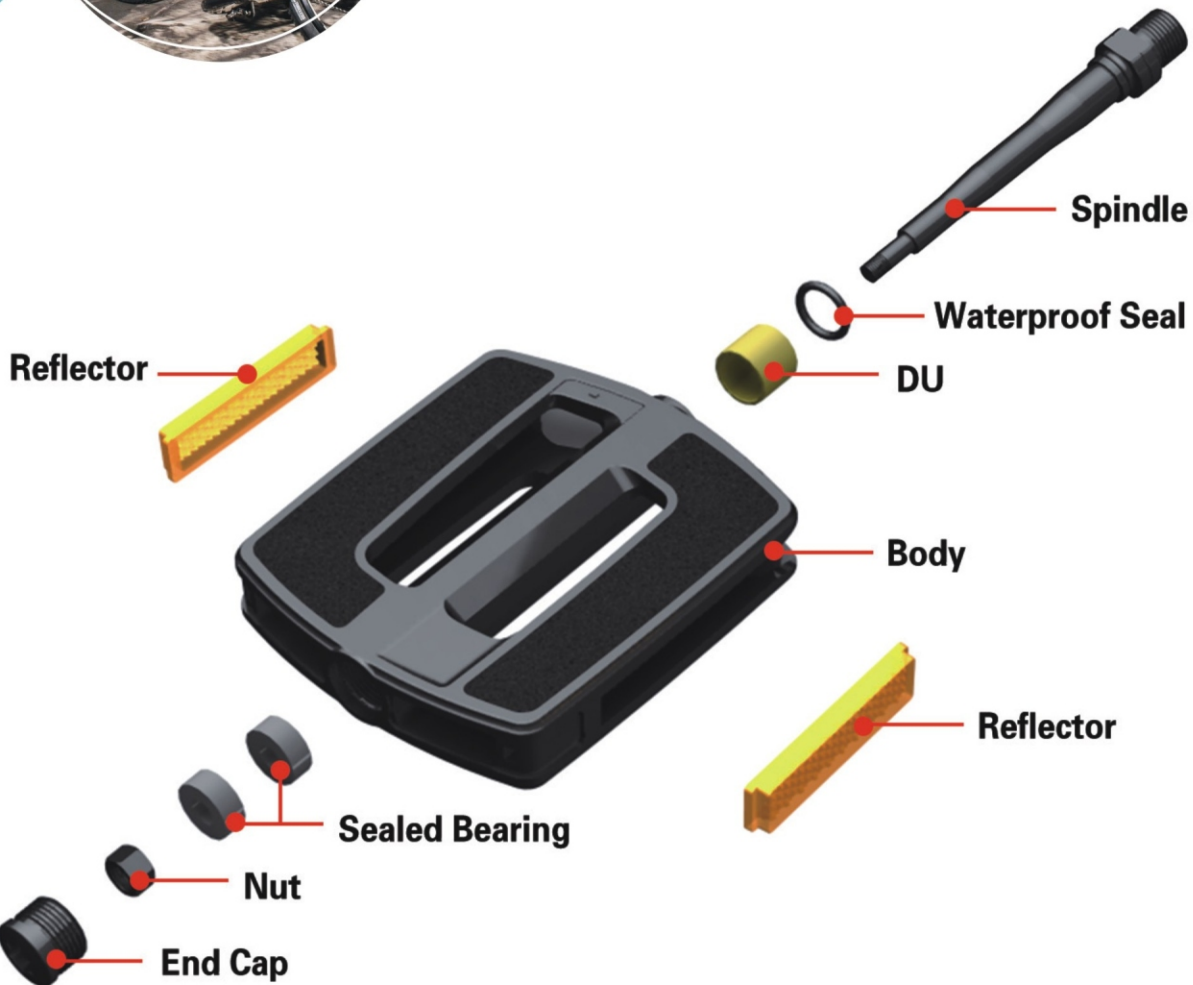

The New Non-slip Pedal and latest reformation for Comfort/city , Trekking and E-bike. Our unique design , thin body provides best comfortable for fashion bikes and city riders. With the Dou-7-shaped sand paper Non-slip zone, the pedal supports any shoes best.



**Model:HF-808** COMFORT/CITY  
Body:Plastic body W/Non-slip Sand tread  
Bearing:Sealed  
Axle:Boron  
Size:110x86mm  
Weight:Ball typr 333g/pr



**Model:HF-703** DUAL FUNCTION  
Body: Aluminum Barrel polished /ED  
Bearing:Sealed  
Axle:Boron  
Size:110x94mm  
Weight:Ball typr 508g/pr



**Model:HF-705** FREERIDE/CITY  
Body:Aluminum Barrel polished/Coating  
Bearing:DU bearing or Sealed  
Axle:CR-MO/Boron  
Size:115x100mm  
Weight:Ball typr 370g/pr

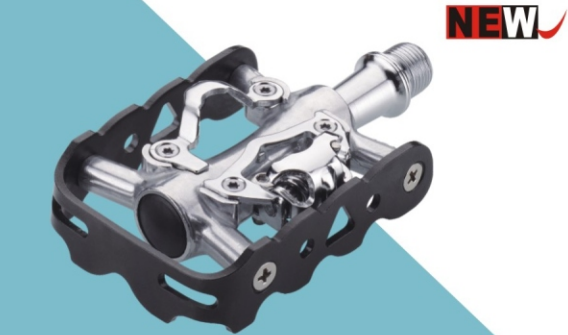

**Model:HF-707** DUAL FUNCTION  
Body: Aluminum Barrel polished polished/Anodized  
Bearing:DU bearing or Sealed  
Axle:CR-MO/Boron  
Size:101x63mm  
Weight:Ball typr 328g/pr



FREERIDE

FREERIDE/CITY / MTB / BMX PEDAL



**Model:HF-630** **FREERIDE**  
Body:PC material W/Replaceable Pins  
Bearing:Sealed/DU  
Axle:CR-MO/Boron  
Size:110x105mm  
Weight:Ball typr 374g/pr



**Model:HF-635** **FREERIDE**  
Body:Aluminum Extruded/CNC machined  
Bearing:Sealed/DU  
Axle:CR-MO/Boron  
Size:110x105mm  
Weight:Ball typr 330g/pr



**Model:HF-615** **FREERIDE**  
Body:Aluminum Extruded/CNC machined  
Bearing:Sealed/DU  
Axle:CR-MO/Boron  
Size:121x110mm  
Weight:Ball typr 368g/pr



**Model:HF-605** **MTB**  
Body:Aluminum Extruded/CNC machined  
Bearing:Sealed/DU  
Axle:CR-MO/Boron  
Size:100x90mm  
Weight:Ball typr 320g/pr



**Model:HF-606** **BMX**  
Body:Aluminum Extruded/CNC machined  
Bearing:Sealed/DU  
Axle:CR-MO/Boron  
Size:110x100mm  
Weight:Ball typr 361g/pr



**Model:HF-624** **FREERIDE**  
Body:Aluminum Extruded/CNC machined  
Bearing:Sealed/DU  
Axle:CR-MO/Boron  
Size:112x101mm  
Weight:Ball typr 345g/pr



**Model:HF-631** **FREERIDE**  
Body:Aluminum Extruded/CNC machined  
Bearing:Sealed/DU  
Axle:CR-MO/Boron  
Size:110x100mm  
Weight:Ball typr 330g/pr



**Model:HF-623** **FREERIDE**  
Body:Aluminum Extruded/CNC machined  
Bearing:Sealed/DU  
Axle:CR-MO/Boron  
Size:100x101mm  
Weight:Ball typr 282g/pr



**Model:HF-607** **MTB**  
Body:Aluminum Extruded/CNC machined  
Bearing:Sealed/DU  
Axle:CR-MO/Boron  
Size:100x70mm  
Weight:Ball typr 200g/pr



**Model:HF-895** **MTB/BMX**  
Body:Aluminum Extruded/CNC machined  
Bearing:Sealed/DU  
Axle:CR-MO/Boron  
Size:113x112mm  
Weight:Ball typr 490g/pr



**Model:HF-628** **FREERIDE**  
Body:Aluminum Extruded/CNC machined  
Bearing:Sealed/DU  
Axle:CR-MO/Boron  
Size:93x100mm  
Weight:Ball typr 328g/pr



**Model:HF-625** **FREERIDE**  
Body:Aluminum Extruded/CNC machined  
Bearing:Sealed/DU  
Axle:CR-MO/Boron  
Size:110x101mm  
Weight:Ball typr 342g/pr



**Model:HF-626** **FREERIDE**  
Body:Aluminum Extruded/CNC machined  
Bearing:Sealed/DU  
Axle:CR-MO/Boron  
Size:103x101mm  
Ball typr 630g/pr



**Model:HF-886** **MTB**  
Body:Aluminum Extruded/CNC machined  
Bearing:Sealed/DU  
Axle:CR-MO/Boron  
Size:92x62mm  
Weight:Ball typr 203g/pr





FREERIDE/CITY / MTB / BMX PEDAL

PEDAL DU BEARING SYSTEM



**Model:HF-895B** MTB/BMX  
Body:Aluminum Barrel polished/ED  
Bearing:Advanced ball bearing  
Axle:Boron  
Size:113x112mm  
Weight:Ball typr 334g/pr



**Model:HF-603S** MTB/BMX  
Body:Aluminum Extruded/CNC machined  
Bearing:Sealed  
Axle:CR-MO/Boron  
Size:110x100mm  
Weight:Ball typr 388g/pr



**Model:HF-603** MTB/BMX  
Body:Aluminum Barrel polished  
Bearing:DU bearing  
Axle:Boron  
Size:110x100mm  
Weight:Ball typr 390g/pr



**Model:HF-862B** FREERIDE/CITY  
Body:Aluminum Barrel polished/Coating  
Bearing:Sealed  
Axle:CR-MO/Boron  
Size:115x100mm  
Weight:4Ball typr 496g/pr



**Model:HF-862C** FREERIDE/CITY  
Body:Aluminum Barrel polished/ED  
Bearing:DU bearing  
Axle:Boron  
Size:115x100mm  
Weight:Ball typr 270g/pr

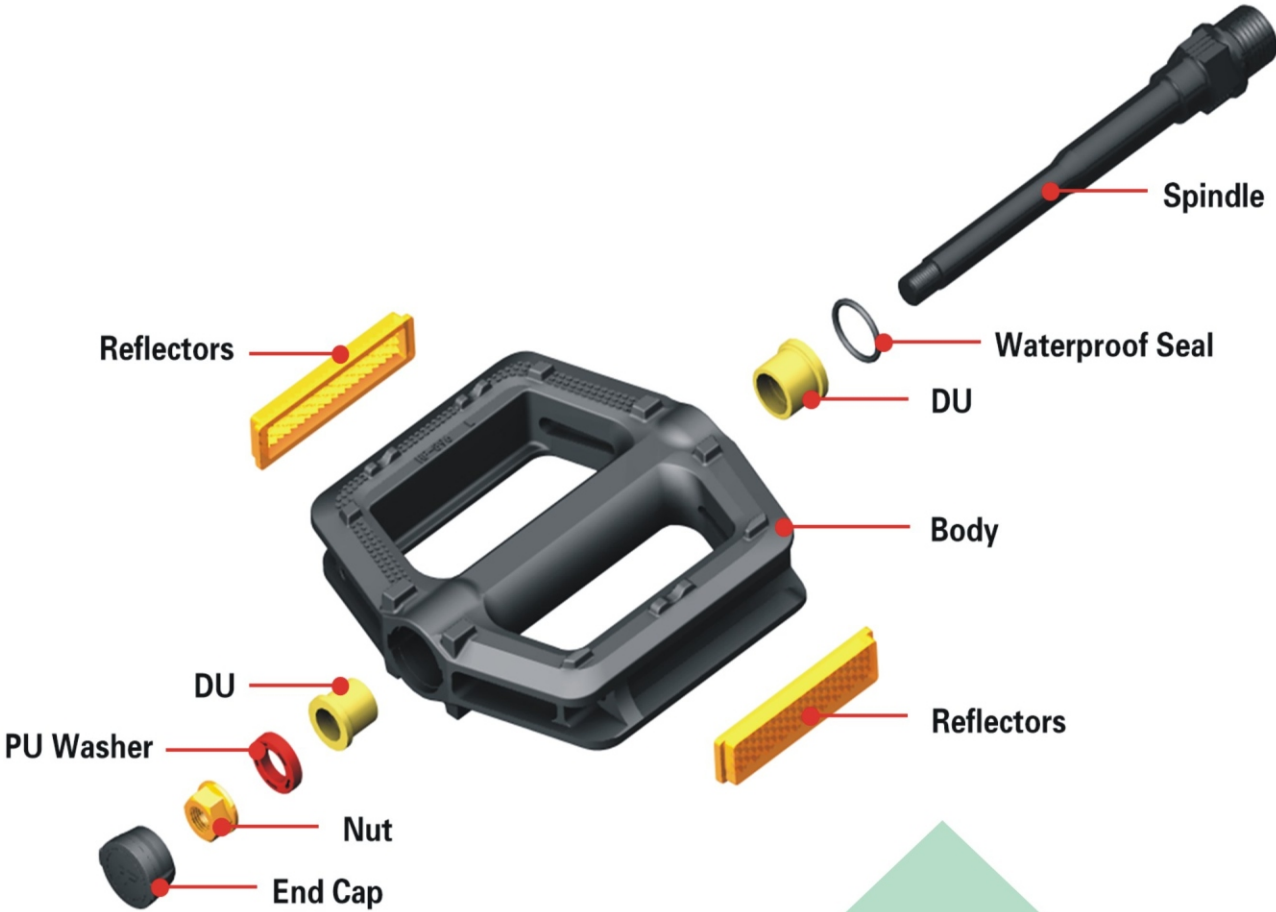



COMFORT/CITY/MTB PEDAL



**Model:HF-893** CITY  
Body:Aluminum ED/CNC machined  
Bearing:DU bearing  
Axle:Boron  
Size:105x82mm  
Weight:Ball typr 292g/pr



**Model:HF-863A** MTB  
Body:Aluminum Barrel polished  
Bearing:DU bearing  
Axle:Boron  
Size:100x80mm  
Weight:Ball typr 310g/pr



**Model:HF-609** COMFORT/CITY  
Body:Aluminum Barrel polished W/inlaid TPR tread  
Bearing:DU bearing  
Axle:Boron  
Size:110x81mm  
Weight:Ball typr 333g/pr



**Model:HF-608** COMFORT/CITY  
Body:2-Pieces PP body w/inlaid TPR tread  
Bearing:DU bearing  
Axle:Boron  
Size:107x81mm  
Weight:Ball typr 296g/pr



**Model:HF-810** COMFORT  
Body:One-Piece Black PP  
Bearing:DU bearing  
Axle:Boron  
Size:100x80mm  
Weight:Ball typr 237g/pr



**Model:HF-810A** COMFORT  
Body:2-Pieces PP body w/inlaid TPR tread  
Bearing:DU bearing  
Axle:Boron  
Size:100x80mm  
Weight:Ball typr 240g/pr



**Model:HF-610** COMFORT  
Body:Aluminum Barrel polished  
body w/pp cage&inlaid TPR tread  
Bearing:DU bearing  
Axle:Boron  
Size:100x80mm  
Weight:Ball typr 310g/pr



**Model:HF-860** COMFORT/CITY  
Body:One-Piece Black PP  
Bearing:DU bearing  
Axle:Boron  
Size:107x90mm  
Weight:Ball typr 266g/pr



**Model:HF-897** COMFORT/CITY  
Body:One-Piece Plastic  
Bearing:DU bearing  
Axle:Boron  
Size:110x80mm  
Weight:Ball typr 286g/pr



**Model:HF-891** MTB  
Body:Black Nylon  
Bearing:DU bearing  
Axle:Boron  
Cage: Aluminum Anodized  
Size:102x80mm  
Weight:Ball typr 264g/pr



**Model:HF-863B** MTB  
Body:Aluminum Barrel polished  
Bearing:DU bearing  
Axle:Boron  
Cage: Aluminum Anodized  
Size:100x80mm  
Weight:Ball typr 310g/pr



**Model:HF-890** COMFORT/CITY  
Body:One-Piece Black PP  
Bearing:DU bearing  
Axle:Boron  
Size:105x82mm  
Weight:Ball typr 247g/pr



**Model:HF-702** COMFORT/CITY  
Body:One-Piece Black PP  
Bearing:DU bearing  
Axle:Boron  
Size:110x84mm  
Weight:Ball typr 239g/pr





# PEDAL BALL BEARING SYSTEM

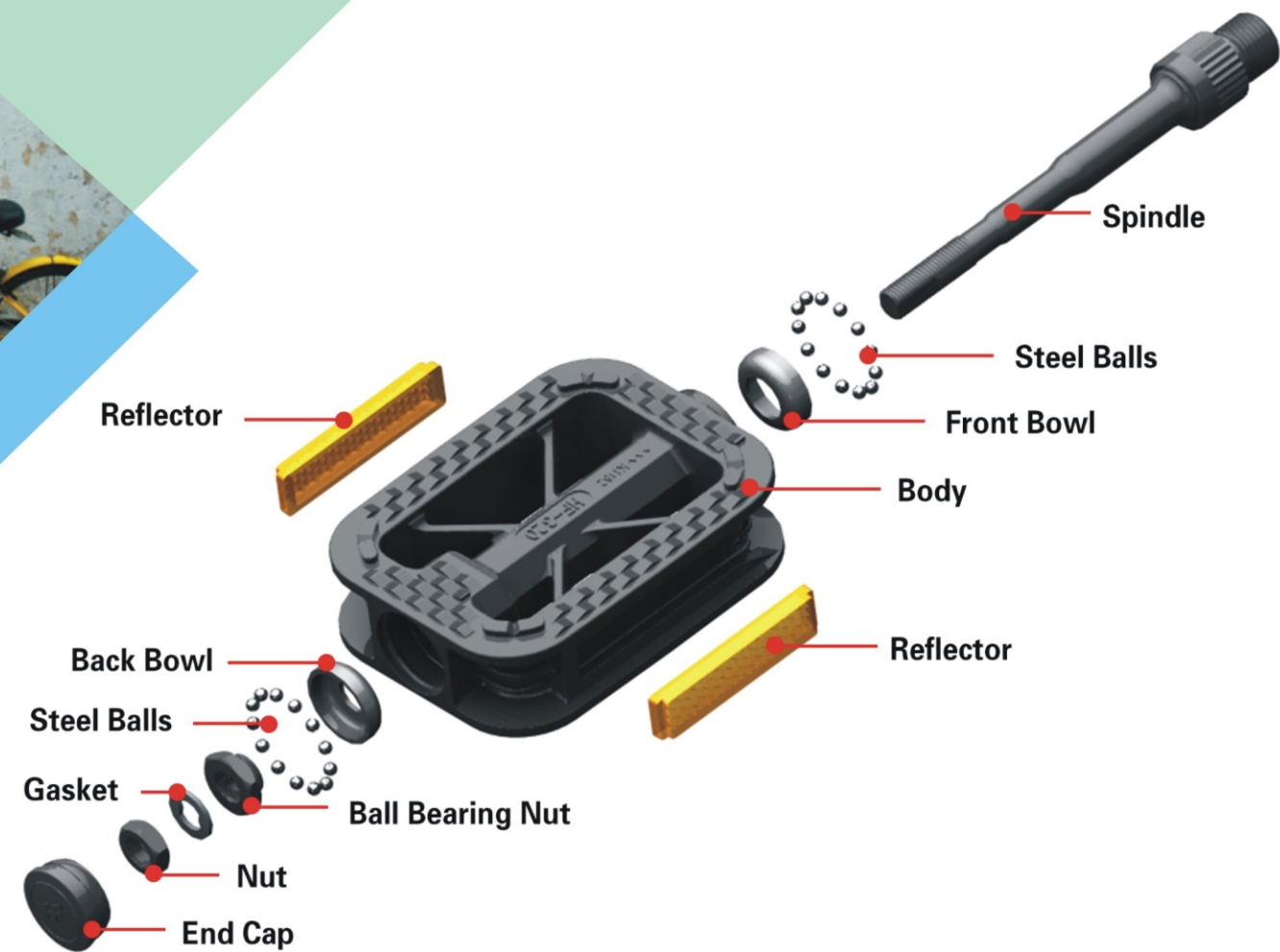

## COMFORT/CITY Classic Type PEDAL



**Model:HF-611** MTB/CITY For Classic Bike  
Body:Aluminum Barrel polished  
Bearing:Ball bearing  
Axle:Boron  
Cage:Aluminum Anodized



**Model:HF-612** COMFORT/CITY For Classic Bike  
Body:Aluminum Barrel polished  
Bearing:Ball bearing  
Axle:Boron  
Cage:PP cage W/inlaid TPR tread  
Size:112x78mm  
Weight:Ball typr 448g/pr



**Model:HF-613** COMFORT/CITY For Classic Bike  
Body:Aluminum Barrel polished  
Bearing:Ball bearing  
Axle:Boron  
Cage:PP cage W/inlaid TPR tread  
Size:110x80mm  
Weight:Ball typr 423g/pr





MTB/BMX PEDAL



**Model:HF-805** MTB/BMX  
Body:Aluminum Barrel polished/ED  
Bearing:Advanced ball bearing  
Axle:Boron  
Size:110x100mm  
Weight:Ball typr 363g/pr



**Model:HF-832** MTB/BMX  
Body:Aluminum Barrel polished/Silver  
Bearing:Ball bearing  
Axle:Boron  
Size:112x105mm  
Weight:Ball typr 414g/pr



**Model:HF-809** MTB/BMX  
Body:Aluminum Barrel polished/ED  
Bearing:Ball bearing  
Axle:Boron  
Size:112x105mm  
Weight:Ball typr 382g/pr



**Model:HF-892** MTB/BMX  
Body:Aluminum Barrel polished  
Bearing:Ball bearing  
Axle:Boron  
Size:108x100mm  
Weight:Ball typr 446g/pr



**Model:HF-601** MTB/BMX  
Body:Aluminum Barrel polished/ED  
Bearing:Ball bearing  
Axle:Boron  
Size:108x95mm  
Weight:Ball typr 404g/pr



**Model:HF-882** MTB/BMX  
Body:Aluminum Barrel polished/ED  
Bearing:Ball bearing  
Axle:Boron  
Size:110x105mm  
Weight:Ball typr 448g/pr



**Model:HF-850** BMX/KID' S BIKE  
Body:Aluminum Barrel polished  
Bearing:Ball bearing  
Axle:Boron  
Size:100x100mm  
Weight:Ball typr 303g/pr



**Model:HF-872** MTB/BMX  
Body:Aluminum Barrel polished/Coating  
Bearing:Ball bearing  
Axle:Boron  
Size:113x115mm  
Weight:Ball typr 482g/pr



**Model:HF-991** MTB/BMX  
Body:Aluminum Barrel polished  
Bearing:Ball bearing  
Axle:Boron  
Size:110x155mm  
Weight:Ball typr 452g/pr

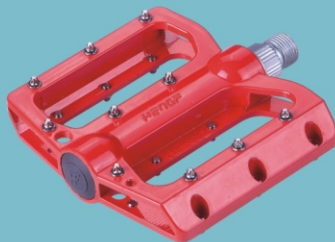

**Model:HF-882S** MTB/BMX  
Body:Aluminum Extruded/CNC machined  
Bearing:Sealed  
Axle: CR-MO/Boron  
Size:110x105mm  
Weight:Ball typr 426g/pr





MTB PEDAL



**Model:HF-866A** MTB  
Body: Black /PP Nylon/PP  
Bearing:Ball bearing  
Axle:Boron  
Cage:Steel ED  
Size:102x80mm  
Weight:Ball typr 390g/pr



**Model:HF-866** MTB  
Body: Black Nylon  
Bearing:Ball bearing  
Axle:Boron  
Cage:Aluminum Anodized  
Size:102x80mm  
Weight:Ball typr 328g/pr



**Model:HF-602** MTB  
Body:Aluminum Barrel polished  
Bearing:Ball bearing  
Axle: Steel or Boron  
Size:102x82mm  
Weight:Ball typr 371g/pr



**Model:HF-879** COMFORT/CITY  
Body: Aluminum Barrel polished W/inlaid TPR tread  
Bearing:Ball bearing  
Axle:Boron  
Size:110x70mm  
Weight:Ball typr 413g/pr



**Model:HF-879A** COMFORT/CITY  
Body: Aluminum Barrel polished W/inlaid TPR tread  
Bearing:Ball bearing  
Axle:Boron



**Model:HF-829** MTB  
Body: Black/PP Nylon/PP  
Bearing:Ball bearing  
Axle:Boron  
Cage:Aluminum Anodized Silver  
Size:102x80mm  
Weight:Ball typr 305g/pr



**Model:HF-858** MTB  
Body: Aluminum Barrel polished/Anodized  
Bearing:Ball bearing  
Axle:Boron  
Cage:Aluminum ED  
Size:100x86mm  
Weight:Ball typr 346g/pr



**Model:HF-825** COMFORT/CITY  
Body: Aluminum Barrel polished W/inlaid TPR tread  
Bearing:Ball bearing  
Axle:Boron  
Size:103x72mm  
Weight:Ball typr 424g/pr



**Model:HF-825A** COMFORT/CITY  
Body: Aluminum Barrel polished W/inlaid TPR tread  
Bearing:Ball bearing  
Axle:Boron  
Size:110x70mm



**Model:HF-835** MTB  
Body:Aluminum Barrel polished  
Bearing:Ball bearing  
Axle:Boron  
Size:102x80mm  
Weight:Ball typr 353g/pr



**Model:HF-857** MTB  
Body:Aluminum Barrel polished  
Bearing:Ball bearing  
Axle:Boron  
Size:110x85mm  
Weight:Ball typr 392g/pr



**Model:HF-868** MTB  
Body:Aluminum Barrel polished  
Bearing:Ball bearing  
Axle:Boron  
Size:110x80mm  
Weight:Ball typr 404g/pr



**Model:HF-821** COMFORT/CITY  
Body: Aluminum Barrel polished W/inlaid TPR tread  
Bearing:Ball bearing  
Axle:Boron  
Size:108x70mm  
Weight:Ball typr 405g/pr



**Model:HF-885** COMFORT/CITY  
Body:Aluminum Barrel polished W/Non-slip tread  
Bearing:DU bearing  
Axle:Boron  
Size:112x92mm





FOLDING PEDAL



**Model:HF-661** FOLDING  
Body:3-Pieces Nylon  
Bearing:DU bearing  
Axle:Steel  
Size:109x70mm  
Weight:Ball typr 378g/pr



**Model:HF-662** FOLDING  
Body:2-Pieces PC  
Bearing:DU bearing  
Axle:Boron  
Size:103x73m  
Weight:Ball typr 294g/pr



**Model:HF-663** FOLDING  
Body:2-Pieces PC W/Non-slip Sand tread  
Bearing:DU bearing  
Axle:Boron  
Size:103x73m  
Weight:Ball typr 300g/pr



**Model:HF-665** FOLDING  
Body:Aluminum & PC  
Bearing:DU bearing  
Axle:Boron  
Size:103x786m  
Weight:Ball typr 358g/pr



**Model:HF-665A** FOLDING  
Body:2-Pieces PC  
Bearing:DU bearing  
Axle:Boron  
Size:103x86m  
Weight:Ball typr 298g/pr



**Model:HF-660** CHILDREN'S FOLDING  
Body:3-Pieces Nylon  
Bearing:DU bearing  
Axle:Steel  
Size:95x65mm  
Weight:Ball typr 317g/pr



**Model:HF-880** FOLDING  
Body:3-Pieces Nylon  
Bearing:Ball bearing  
Axle: Boron  
Size:112x70mm  
Weight:Ball typr 429g/pr



**Model:HF-881** FOLDING  
Body:Aluminum & Nylon  
Bearing:Ball bearing  
Axle: Boron  
Size:112x70mm  
Weight:Ball typr 426g/pr



**Model:HF-867** FOLDING  
Body:3-Pieces Nylon body w/inlaid TPR tread  
Bearing:Ball bearing  
Axle:Boron  
Size:110x75mm  
Weight:Ball typr 497g/pr

E-BIKE PEDAL



**Model:HF-680D** E-BIKE  
Body:One-Piece Black PP  
Bearing:Ball bearing  
Axle:Boron  
Size:62x87.5mm  
Weight:Ball typr 247g/pr



**Model:HF-823A** E-BIKE  
Body: One-Piece PP  
Bearing:Ball bearing or W/O Balls  
Axle: Steel or Boron  
Size: 89x83mm  
Weight:Ball typr 268g/pr



**Model:HF-681D** E-BIKE  
Body:One-Piece Black PP  
Bearing:Ball bearing  
Axle:Boron  
Size:68x89.5mm  
Weight:Ball typr 192g/pr



COMFORT/CITY/BEACH CRUISER PEDAL



**Model:HF-811** COMFORT/CITY  
Body: 2-Pieces PP body w/inlaid TPR tread  
Bearing:Ball bearing  
Axle:Boron  
Size:105x72mm  
Weight:Ball typr 307g/pr



**Model:HF-828** COMFORT/CITY BEACH CRUISER  
Body: 2-Pieces PP body w/inlaid TPR tread  
Bearing:Ball bearing  
Axle:Boron  
Size:115x83mm  
Weight:Ball typr 334g/pr



**Model: HF-831** COMFORT/CITY BEACH CRUISER  
Body: 2-Pieces PP body w/inlaid TPR tread  
Bearing:Ball bearing or W/O balls  
Axle:Steel or Boron  
Size:115x90mm  
Weight:Ball typr 374g/pr



**Model: HF-875** COMFORT/CITY BEACH CRUISER  
Body: 2-Pieces PP body w/inlaid TPR tread  
Bearing:Ball bearing or W/O balls  
Axle:Steel or Boron  
Size:115x90mm  
Weight:Ball typr 380g/pr



**Model:HF-838** COMFORT/CITY  
Body: 2-Pieces PP body w/inlaid TPR tread  
Bearing:Ball bearing  
Axle:Boron  
Size:110x75mm  
Weight:Ball typr 375g/pr



**Model:HF-837** COMFORT/CITY  
Body: 2-Pieces PP body w/inlaid TPR tread  
Bearing:Ball bearing  
Axle:Boron  
Size:105x70mm  
Weight:Ball typr 297g/pr



**Model:HF-806** COMFORT/CITY  
Body: 2-Pieces PP body w/inlaid TPR tread  
Bearing:Ball bearing  
Axle:Boron  
Size:108x72mm  
Weight:Ball typr 339g/pr



**Model:HF-827A** BMX/CITY  
Body:One-Piece Black PP  
Bearing:Ball bearing  
Axle:Boron  
Size:108x95mm  
Weight:Ball typr 332g/pr



**Model:HF-827** MTB/BMX  
Body:One-Piece Black PP  
Bearing:Ball bearing or W/O balls  
Axle:Steel or Boron  
Size:110x105mm  
Weight:Ball typr 313g/pr



**Model:HF-855** BMX  
Body:One-Piece Black PP  
Bearing:Ball bearing  
Axle:Boron  
Size:115x95mm  
Weight:Ball typr 355g/pr



**Model:HF-855C** BMX  
Body:One-Piece Black PP w/steel CP  
Bearing:Ball bearing  
Axle:Boron  
Size:115x95mm  
Weight:Ball typr 365g/pr



**Model:HF-865** MTB/BMX  
Body:One-Piece Black PP  
Bearing:Ball bearing  
Axle:Boron  
Size:115x110mm  
Weight:Ball typr 354g/pr



**Model:HF-852** MTB/BMX  
Body:One-Piece Black PP  
Bearing:Ball bearing  
Axle:Boron  
Size:110x105mm  
Weight:Ball typr 363g/pr



**Model:HF-988** MTB/BMX  
Body:One-Piece Black PP  
Bearing:Ball bearing  
Axle:Boron  
Size:110x110mm  
Weight:Ball typr 398g/pr



MTB/BMX/CITY PEDAL



**Model:HF-896** MTB/BMX  
Body:One-Piece Plastic  
Bearing:DU bearing  
Axle:Boron  
Size:107x98mm  
Weight:Ball typr 257g/pr



**Model:HF-701** MTB/BMX  
Body:One-Piece Black PP  
Bearing:DU bearing  
Axle:Boron  
Size:107x102mm  
Weight:Ball typr 261g/pr



**Model:HF-990** MTB/BMX  
Body:One-Piece PP/ PC  
Bearing:Ball bearing  
Axle:Boron  
Size:110x100mm  
Weight:Ball typr 300g/pr



**Model:HF-883** MTB/BMX  
Body:One-Piece PP/Black Nylon  
Bearing:Ball bearing  
Axle:Boron  
Size:108x103mm  
Weight:Ball typr 329g/pr



**Model:HF-859** MTB/BMX  
Body:Plastic body W/Sand paper&Pins  
Bearing:DU bearing  
Axle:Boron  
Size:108x91mm  
Weight:Ball typr 316g/pr



**Model:HF-706** MTB/BMX  
Body:One-Piece Nylon  
Bearing:DU bearing  
Axle:Boron  
Size:110x103mm  
Weight:Ball typr 344g/pr



**Model:HF-820** MTB/BMX  
Body:One-Piece Black PP  
Bearing:Ball bearing or W/O balls  
Axle:Steel or Boron  
Size:110x100mm  
Weight:Ball typr 318g/pr



**Model:HF-830** MTB/BMX  
Body:One-Piece Black PP  
Bearing:Ball bearing or W/O balls  
Axle:Steel or Boron  
Size:108x95mm  
Weight:Ball typr 317g/pr



**Model:HF-987** MTB/BMX  
Body:One-Piece Black PP  
Bearing:Ball bearing or W/O balls  
Axle:Steel or Boron  
Size:105x95mm  
Weight:Ball typr 324g/pr

NEW



**Model:HF-899** MTB/BMX/CITY  
Body:One-Piece Black PP  
Bearing:Ball bearing or W/O balls  
Axle:Boron or Steel  
Size:108x97mm  
Weight:Ball typr 298g/pr



**Model:HF-898** MTB/BMX/CITY  
Body:One-Piece Black PP  
Bearing:Ball bearing or W/O balls  
Axle:Boron or Steel  
Size:110x100mm  
Weight:Ball typr 333g/pr



**Model:HF-856** MTB/BMX  
Body:One-Piece Black PP  
Bearing:DU bearing  
Axle:Boron  
Size:107x100mm  
Weight:Ball typr 282g/pr



**Model:HF-839** MTB  
Body:One-Piece Black PP  
Bearing:Ball bearing or W/O balls  
Axle:Steel or Boron  
Size:110x85mm  
Weight:Ball typr 300g/pr



**Model:HF-871** MTB  
Body:One-Piece Black PP  
Bearing:Ball bearing or W/O balls  
Axle:Steel or Boron  
Size:110x85mm  
Weight:Ball typr 346g/pr

MTB/BMX PEDAL





MTB/COMFORT/CITY PEDAL



**Model:HF-813** COMFORT/CITY  
Body:One-Piece Black PP  
Bearing:Ball bearing or W/O balls  
Axle:Steel or Boron  
Size:108x72mm  
Weight:Ball typr 318g/pr



**Model:HF-826** COMFORT/CITY  
Body:One-Piece Black PP  
Bearing:Ball bearing or W/O balls  
Axle:Steel or Boron  
Size:112x78mm  
Weight:Ball typr 324g/pr



**Model:HF-320A** COMFORT/CITY  
Body:One-Piece Black PP  
Bearing:Ball bearing or W/O balls  
Axle:Steel or Boron  
Size:108x70mm  
Weight:Ball typr 314g/pr



**Model:HF-877** COMFORT/CITY  
Body:One-Piece Black PP  
Bearing:Ball bearing or W/O balls  
Axle:Steel or Boron  
Size:108x75mm  
Weight:Ball typr 328g/pr



**Model:HF-876** CHILDREN' S/20" MTB  
Body:One-Piece Black PP  
Bearing:Ball bearing or W/O balls  
Axle:Steel or Boron  
Size:105x75mm  
Weight:Ball typr 276g/pr



**Model:HF-878** MTB  
Body:One-Piece Black PP  
Bearing:Ball bearing or W/O balls  
Axle:Steel or Boron  
Size:105x85mm  
Weight:Ball typr 300g/pr



**Model:HF-853** MTB  
Body:One-Piece Black PP  
Bearing:Ball bearing or W/O balls  
Axle:Steel or Boron  
Size:108x83mm  
Weight:Ball typr 319g/pr



**Model:HF-851** COMFORT/CITY  
Body:One-Piece Black PP  
Bearing:Ball bearing or W/O balls  
Axle:Steel or Boron  
Size:115x75mm  
Weight:Ball typr 313g/pr



**Model:HF-200** COMFORT/CITY  
Body:One-Piece Black PP  
Bearing:Ball bearing or W/O balls  
Axle:Steel or Boron  
Size:108x72mm  
Weight:Ball typr 320g/pr



**Model:HF-320** COMFORT/CITY  
Body:One-Piece Black PP  
Bearing:Ball bearing or W/O balls  
Axle:Steel or Boron  
Size:108x70mm  
Weight:Ball typr 308g/pr



**Model:HF-806A** COMFORT/CITY  
Body:One-Piece Black PP  
Bearing:Ball bearing or W/O balls  
Axle:Steel or Boron  
Size:108x72mm  
WeightBall typr 333g/pr



# PEDAL BALL-LESS BEARING SYSTEM

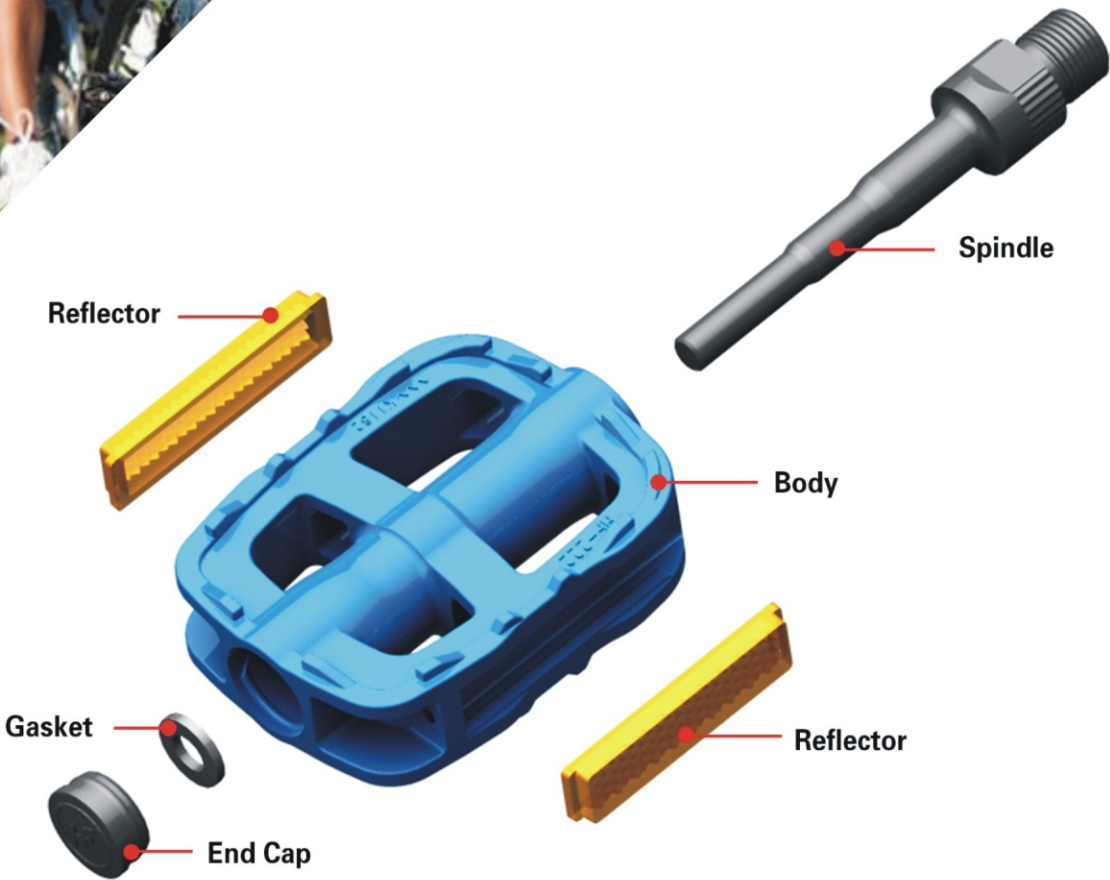

## KID'S BIKE PEDAL



**Model:HF-225/225L** CHILDREN'S  
Body:One-Piece PP  
Bearing:W/O Balls  
Axle:Steel  
Size:83x78/90X84mm  
Weight:Ball typr 190g/204g/pr



**Model:HF-222** CHILDREN'S  
Body:One-Piece PP  
Bearing:DU bearing or W/O Balls  
Axle:Boron or Steel  
Size:93x60mm  
Weight:Ball typr 217g/pr



**Model:HF-221** CHILDREN'S  
Body:One-Piece PP  
Bearing:W/O Balls  
Axle:Steel  
Size:80x58mm  
Weight:Ball typr 191g/pr



**Model:HF-223** CHILDREN'S  
Body:One-Piece PP  
Bearing:W/O Balls  
Axle:Steel  
Size:96x65mm  
Weight:Ball typr 218g/pr



**Model:HF-315** CHILDREN'S  
Body:One-Piece Black PP  
Bearing:Ball bearing or W/O balls  
Axle:Steel or Boron  
Size:93x72mm  
Weight:Ball typr 237g/pr



**Model:HF-319** CHILDREN'S  
Body:One-Piece Black PP  
Bearing:W/O Balls  
Axle:Steel  
Size:96x75mm  
Weight:Ball typr 236g/pr



**Model:HF-318** CHILDREN'S  
Body:One-Piece PP  
Bearing:W/O balls  
Axle:Steel  
Size: 92x80mm  
Weight:Ball typr 232g/pr



**Model:HF-819** CHILDREN'S  
Body:One-Piece PP  
Bearing:W/O balls  
Axle:Steel  
Size:95x70mm  
Weight:Ball typr 244g/pr



**Model:HF-801** CHILDREN'S  
Body:One-Piece PP  
Bearing:W/O balls  
Axle:Steel  
Size:90x84mm  
Weight:Ball typr 217g/pr



KID'S BIKE PEDAL



**Model:HF-696** CHILDREN'S  
Body: One-Piece PP  
Bearing:DU bearing or W/O Balls  
Axle:Boron or Steel  
Size: 95x85mm  
Weight:Ball typr 230g/pr



**Model:HF-873** CHILDREN'S  
Body: 2-Piece PP Corlors inland any color  
Bearing:W/O Balls  
Axle:Steel  
Size: 100x80mm  
Weight:Ball typr 239g/pr



**Model:HF-316** CHILDREN'S  
Body: One-Piece PP  
Bearing:Ball bearing or W/O Balls  
Axle:Steel or Boronl  
Size: 100x71mm  
Weight:Ball typr 203g/pr



**Model:HF-910** CHILDREN'S  
Body:One-Piece PP  
Bearing:W/O balls  
Axle:Steel  
Size:95x65mm  
Weight:Ball typr 214g/pr



**Model:HF-823A** CHILDREN'S  
Body: One-Piece PP  
Bearing:Ball bearing or W/O Balls  
Axle:Steel or Boron  
Size: 89x83mm  
Weight:Ball typr 268g/pr



**Model:HF-824A** CHILDREN'S  
Body: One-Piece PP  
Bearing:Ball bearing or W/O Balls  
Axle:Steel or Boron  
Size: 87x78mm  
Weight:Ball typr 254g/pr



**Model:HF-910-1** CHILDREN'S  
Body:One-Piece PPW/any logo labels  
Bearing:W/O balls  
Axle:Steel  
Size:95x65mm  
Weight:Ball typr 242g/pr



**Model:HF-815** CHILDREN'S  
Body:One-Piece PP  
Bearing:W/O balls  
Axle:Steel  
Size:95x65mm  
Weight:Ball typr 240g/pr



**Model:HF-815L** CHILDREN'S  
Body:One-Piece PP  
Bearing:Ball bearing  
Axle:Boron  
Size: 103 x 71mm  
Weight:Ball typr 323g/pr



**Model: HF-818** CHILDREN'S  
Body: One-Piece PP  
Bearing:Ball bearing or W/O Balls  
Axle:Steel or Boron  
Size: 100x71mm  
Weight:Ball typr 256g/pr



**Model:HF-822** CHILDREN'S  
Body: One-Piece PP  
Bearing:Ball bearing or W/O Balls  
Axle:Steel or Boron  
Size: 100x75mm  
Weight:Ball typr 245g/pr



**Model:HF-833** CHILDREN'S  
Body: One-Piece PP  
Bearing:W/O Balls  
Axle:Steel  
Size: 100x70mm  
Weight:Ball typr 207g/pr



**Model:HF-312** CHILDREN'S  
Body:One-Piece PP  
Bearing:W/O balls  
Axle:Steel  
Size:88x55mm  
Weight:Ball typr 154g/pr



**Model:HF-816** CHILDREN'S  
Body:One-Piece PP  
Bearing:W/O balls  
Axle:Steel  
Size:90x60mm  
Weight:Ball typr 183g/pr



**Model:HF-812** CHILDREN'S  
Body:One-Piece PP  
Bearing:W/O balls  
Axle:Steel  
Size:90x60mm  
Weight:Ball typr 180g/pr





KID'S BIKE PEDAL



**Model:HF-311** CHILDREN'S  
Body:2-Pieces PP body w/inlaid TPR tread  
Bearing:DU bearing  
Axle:Boron  
Size:96x72mm  
Weight:Ball typr 268g/pr



**Model:HF-311A** CHILDREN'S  
Body:2-Pieces PP body w/inlaid TPR tread& End Reflector  
Bearing:DU bearing  
Axle:Boron  
Size:96x72mm  
Weight:Ball typr 250g/pr



**Model:HF-802** CHILDREN'S  
Body: 2-Piece PP Body w/inlaid TPR tread  
Bearing:W/O balls  
Axle:Steel  
Size:90x78mm  
Weight:Ball typr 262g/pr



**Model:HF-902** CHILDREN'S  
Body:2-Pieces PP body w/inlaid TPR tread  
Bearing:Ball bearing  
Axle:Boron  
Size:90x78mm  
Weight:Ball typr 292g/pr



**Model:HF-220** CHILDREN'S  
Body:2-Piece PP Body w/inlaid TPR tread  
Bearing:W/ balls  
Axle:Boron  
Size:90x60mm  
Weight:Ball typr 310g/pr



**Model: HF-802-1** CHILDREN'S  
Body:One-Piece PP  
Bearing:W/O balls  
Axle:Steel  
Size:90x70mm  
Weight:Ball typr 255g/pr



**Model: HF-803** COMFORT/KID'S  
Body: One-Piece PP Black  
Bearing:Ball bearing or W/O Balls  
Axle:Steel or Boron  
Size: 108x82mm  
Weight:Ball typr 300g/pr



**Model:HF-870** CHILDREN'S  
Body: 2-Piece PP White inland color  
Bearing:W/O Balls  
Axle:Steel  
Size: 95x80mm  
Weight:Ball typr 257g/pr



**Model:HF-817** CHILDREN'S  
Body:One-Piece PP  
Bearing:W/O balls  
Axle:Steel  
Size:90x60mm  
Weight:Ball typr 211g/pr

EXERCISE PEDAL



**Model:HF-703J** EXERCISE  
Body: Aluminum Barrel polished /ED  
Bearing:Sealed  
Axle:CR-MO/Boron  
Size:110x166mm  
Weight:Ball typr 618g/pr



**Model:HF-805J** EXERCISE  
Body: Aluminum Barrel polished /ED  
Bearing:Ball bearing  
Axle:Boron  
Size:110x166mm  
Weight:5Ball typr 520g/pr



**Model:HF-862J** EXERCISE  
Body: Aluminum Barrel polished /ED  
Bearing:Sealed  
Axle:CR-MO/Boron  
Size:115x164mm  
Weight:Ball typr 560g/pr



**Model:HF-879J** EXERCISE  
Body: Aluminum Barrel polished W/inlaid TPR tread  
Bearing:Ball bearing  
Axle:Boron  
Size:109x161mm  
Weight:Ball typr 556g/pr



**Model:HF-878J** EXERCISE  
Body:One-Piece Black PP  
Bearing:Ball bearing  
Axle:Boron  
Size: 107x152mm  
Weight:Ball typr 384g/pr



**Model:HF-809J** EXERCISE  
Body: Aluminum Barrel polished /ED  
Bearing:Ball bearing  
Axle:Boron  
Size:112x169mm  
Weight:Ball typr 486g/pr



**Model:HF-991J** EXERCISE  
Body: Aluminum Barrel polished /ED  
Bearing:Ball bearing  
Axle:Boron  
Size:108x174mm  
Weight:Ball typr 544g/pr



**Model:HF-895J** EXERCISE  
Body: Aluminum Barrel polished /ED  
Bearing:Sealed  
Axle:CR-MO/Boron  
Size:113x166mm  
Weight:Ball typr 472g/pr



# EXERCISE PEDAL



## Model:HF-106J EXERCISE

Body:One-piecePP/inlaid non-slip  
Cage:PVC strap  
Bearing:Ball bearing  
Axle:Boron  
Size:131x148mm  
Weight:Ball typr 882g/pr



## Model:HF-102J EXERCISE

Body:One-piece Black PP  
Cage:PVC strap  
Bearing:Ball bearing  
Axle:Boron  
Size:122x121mm  
Weight:Ball typr 856g/pr



## Model:HF-101J EXERCISE

Body:2-Pieces PP body w/inlaid TPR tread  
Cage:PVC strap  
Bearing:Ball bearing  
Axle:Boron  
Size:150x141mm  
Weight:Ball typr 824g/pr



## Model:HF-105J EXERCISE

Body:2-Pieces PP body w/inlaid TPR tread  
Cage:PVC strap  
Bearing:Ball bearing  
Axle:Boron  
Size:110x109mm  
Weight:Ball typr 698g/pr

# STRAPS PEDAL



## Model:HF-808J STRAPS

Body:Plastic body W/Non-slip Sand tread  
Bearing:Sealed  
Axle:Boron  
Size:110x86mm  
Weight:Ball typr 378g/pr



## Model:HF-855J STRAPS

Body:One-Piece PP  
Bearing:Ball bearing  
Axle:Boron  
Size:115x95mm  
Weight:Ball typr 466g/pr



## Model:HF-990J STRAPS

Body:One-Piece PC  
Bearing:Ball bearing  
Axle:Boron  
Size:110x100mm



## Model:HF-882J STRAPS

Body:Aluminum Extruded/CNC machined  
Bearing:Sealde  
Axle:CR-MO/Boron  
Size:110x105mm



ACCESSORIES



Model:HF-G01

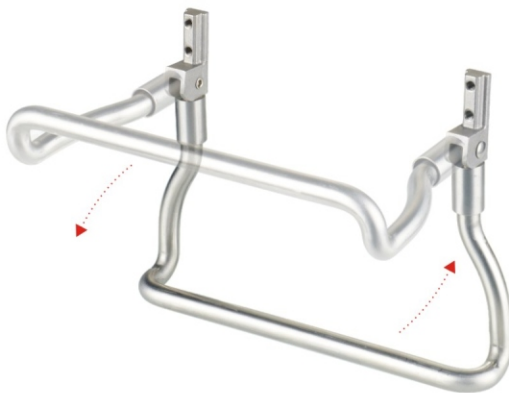

Model:HF-C01



Model:HF-T01  
TOE-CLIP  
Black durable nylon



Model:HF-T02  
TOE-CLIP  
Black durable nylon



Model:HF-S01  
TOE-STRAP  
11.5X450mm woven nylon strao  
Chromeplated steel fastener 50g/pr



Model:HF-SC01  
Cleat kit with improved mud  
clearance features.  
4 degree float



Model:HF-S02  
TOE-STRAP  
11.5X450mm woven nylon strao  
Chromeplated steel fastener 50g/pr

PEDAL SPINDLE EXTENDER & ADAPTER  
--ILLUSTRATION



Protect the thread of crank & Extra space of pedal tread  
& Fit for all type bicycles



Spindle Adapter has 2 kinds of threads,  
1/2" to 9/16" & 9/16 to 1/2"  
free to choose.

Spindle Extender can provide an additional set of protective threads to the  
crank threads.And without worrying about the ware of the crank threads broken,  
while replacing the pedal.

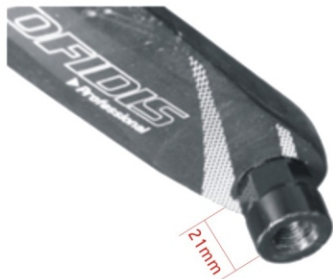

Spindle Extender can increase 21mm widening distance of pedal. The pedal will  
greatly improve the foot's influence on knee width and knee discomfort for big men.



Spindle Adapter has 2 kinds of threads, 1/2" to 9/16" & 9/16 to 1/2" free to choose.  
To fit all kinds of crank bicycles , never mind about distinction between 1-pieces  
to 3-pieces of crank bicycles.



BRAKE LEVER



**Model:HF-201**  
**Colour:**yellow  
**Application:** Ø 19/22.2handlebar  
12"-16" baby carriage  
**Packing:**250sets/ctn  
**Meas:**44X25x23mm



**Model:HF-201**  
**Colour:**black  
**Application:** Ø 19/22.2handlebar  
12"-16" baby carriage  
**Packing:**250sets/ctn  
**Meas:**44X25x23mm



**Model:HF-202**  
**Colour:**white  
**Application:** 12"-18" baby carriage  
**Packing:**200sets/ctn  
**Meas:**44X23x23mm



**Model:HF-202**  
**Colour:**black  
**Application:** 12"-18" baby carriage  
**Packing:**200sets/ctn  
**Meas:**44X23x23mm



**Model:HF-203**  
**Colour:**yellow cp  
**Application:** 12"-18" baby carriage  
**Packing:**200sets/ctn  
**Meas:**44X23x23mm



**Model:HF-203**  
**Colour:**yellow cp  
**Application:** 12"-18" baby carriage  
**Packing:**200sets/ctn  
**Meas:**44X23x23mm



**Model:HF-120**  
**Colour:**black  
**Application:** Ø 19/22.2handlebar  
12"-16" baby carriage  
**Packing:**200sets/ctn  
**Meas:**44X25x23mm



**Model:HF-120**  
**Colour:**black  
**Application:** Ø 19/22.2handlebar  
12"-16" baby carriage  
**Packing:**200sets/ctn  
**Meas:**44X25x23mm



**Model:HF-216**  
**Colour:**black  
**Application:** Ø 22.2handlebar  
gentlewomanly bicycle  
**Packing:**100sets/ctn  
**Meas:**44X25x23mm



**Model:HF-215**  
**Colour:**gray cp  
**Application:** Ø 22.2handlebar  
gentlewomanly bicycle  
**Packing:**100sets/ctn  
**Meas:**44X25x23mm



**Model:HF-128**  
**Colour:**black  
**Application:** Ø 19/22.2handlebar  
12"-18" baby carriage  
**Packing:**300sets/ctn  
**Meas:**50X31x29mm



**Model:HF-128**  
**Colour:**black  
**Application:** Ø 19/22.2handlebar  
12"-18" baby carriage  
**Packing:**300sets/ctn  
**Meas:**50X31x29mm



**Model:HF-188**  
**Colour:**black  
**Application:** baby carriage  
gentlewomanly bicycle  
**Packing:**100sets/ctn  
**Meas:**44X25x23mm



**Model:HF-188-B**  
**Colour:**gray cp  
**Application:** baby carriage  
gentlewomanly bicycle  
**Packing:**100sets/ctn  
**Meas:**44X25x23mm



**Model:HF-218**  
**Colour:**black  
**Application:**bicycle  
**Packing:**100sets/ctn  
**Meas:**50X31x29mm



**Model:HF-218-B**  
**Colour:**aluminum alloy black  
**Application:**bicycle  
**Packing:**100sets/ctn  
**Meas:**50X31x29mm



AFTER MARKET PACKAGE



Atala	ALLIANCE	A&C	ARMOR
BAILEY Art Of Bicycle Assembly	BEMATRIX INTERNATIONAL TRADING COMPANY	BATTLE 邦德·富士达	Bimaq
CSI	CO. UNIC	CAI	1.1
DOREL	DURMAS DURMAS ENTERPRISE CO.,LTD.	DINO Bikes	DENVER BIKE SRL
EVERETT Cycling Innovation	EDGE	ELER	3 DYNACRIFT
AIMA 爱玛 AIMA HI-TECH	好孩子 gb	Hello Kitty	HUFFY
HYPER EXTENSION EXTENSIONS OF HYPER ACTIVITY	雅迪	HEROEXPORTS	impero
见诚企业 MHWACEBIKE.COM.CN	JK JOYKIE	JOYSUN KIDS BICYCLES	KENT A century of cycling
KSTAR	LC BIKE	LOPEZ	Little
MARUI	mbm	MONGOOSE Bicycles	哈啰出行
NI	美团	OXFORD Essential Rider Equipment	PROMADE
PACIFIC	PACIFICCYCLE	RALLEX	ARTES
SHEPPARD INDUSTRIES	SER	STELSMOTO ОДНОВИЩНИЙ ЦИКЛ СТЕЛС №1 В РОССИИ	SCHWINN
Super Max	TANDEM Bicycle	TPT CYCLE	TOPROAD
TESCO	TEDI	UMIT. BISIKLET	TRINX 千里达 TRIN INDUSTRIAL
VELOCI	CABAT	XDS 喜德盛	XLC
滴滴出行	绿源电动车		